

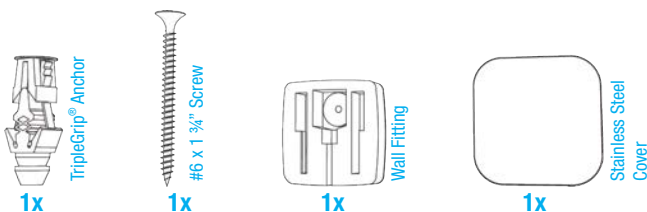

## Wall Hanger Uniq U5164

### PARTS LIST



### Wall Fitting

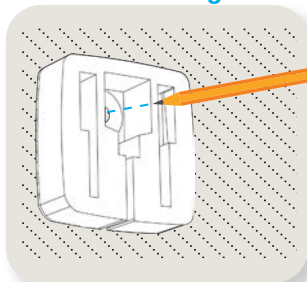

### Pilot Hole

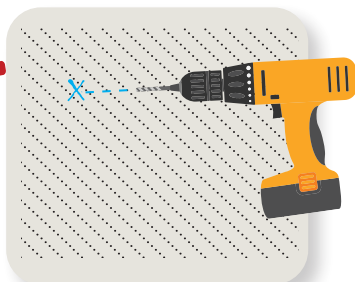

### Anchor

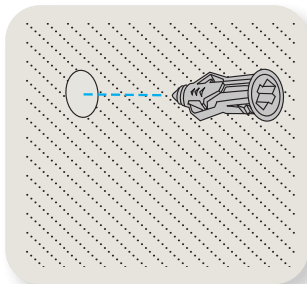

### Fasten Wall Fitting

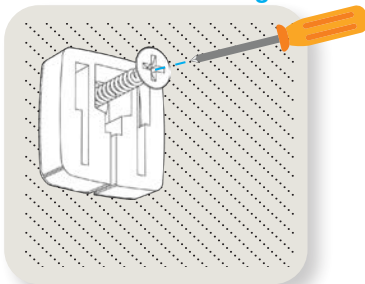

### Insert Cable

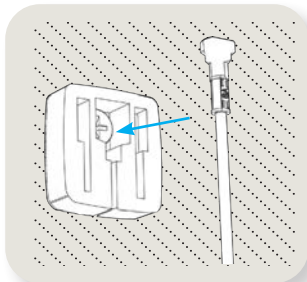

### Adjust Hanging Hook

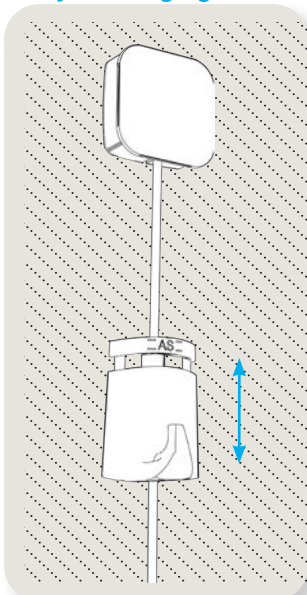

### Place the Cover

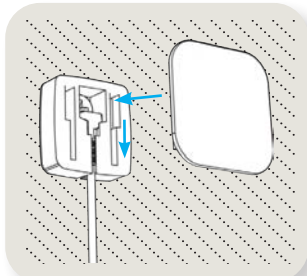

### Warning

The Wall Hanger Uniq is supplied with a flat head screw and TripleGrip® plastic anchor that are suitable for mounting the wall hanger to gypsum panels, lathe and plaster, concrete, masonry block, etc. Property damage and personal injuries can occur from mounting failure. To prevent such failure, it is the responsibility of the installer to select a suitable fastener for a specific installation.

## 1 Wall Fitting Installation

- With a pencil, mark the location where you want to install the Wall Hanger Uniq.
- Use a stud finder or drill 1/16" pilot hole to probe for the wall structure. If no structure is present, expand the hole to 1/4" and insert the supplied anchor.
- Fasten the wall fitting to the prepared hole with the supplied screw.

## 2 Hanging Items

- Insert the Twist-End cable into the wall fitting.
- Place the stainless steel cover on the wall fitting.
- Insert the hanging hook onto the cable and adjust the height of your suspended item.

[www.ashanging.com/en/wall-hanger-uniq](http://www.ashanging.com/en/wall-hanger-uniq)