

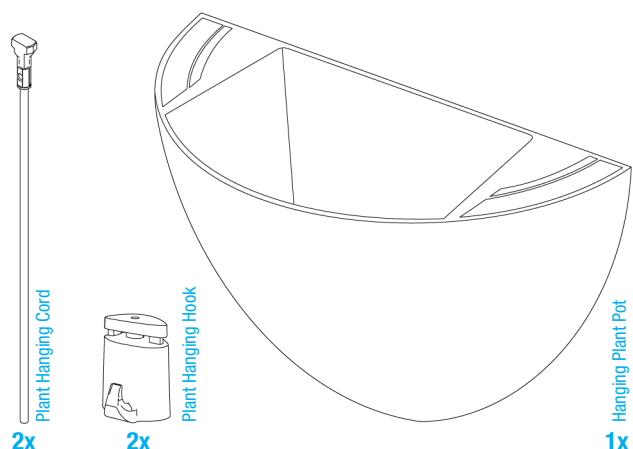

### Hanging Plant Pot K3150, K3152

#### PARTS LIST



#### Warning

This product is supplied with two nylon cords and two hooks designed especially for this product. The hanging plant pot is NOT compatible with any other hanging cables and hooks except for the ones included in the package.

Do not hang it from the Xpo Rail Track.

#### 1 Install cables and hooks

- Slide the supplied hooks on the included cords.
- Insert the cords into the track by twisting them 1/4 on themselves.

#### 2 Adjust hooks at the desired height

- Adjust both hooks at the same height to level the Hanging Plant Pot.
- Then, remove the cords from the track.

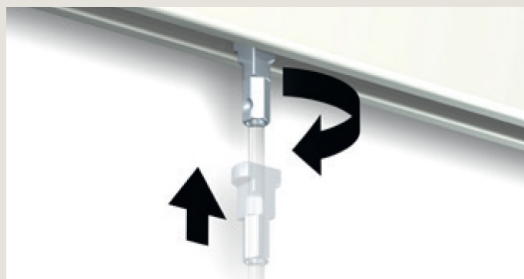
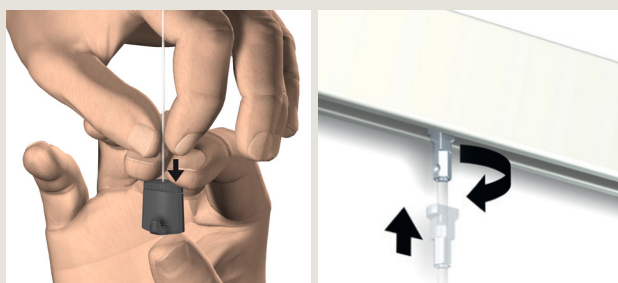

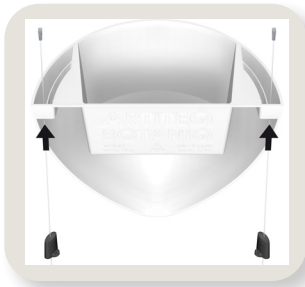

### 3 Insert cords into the Hanging Plant Pot

- Insert the head of the cords (metallic part) through the large opening underneath the Hanging Plant Pot.
- Insert the hooks into one of the 7 holes to hang the Plant Pot against the wall. To ensure that the Hanging Plant Pot is not leaning forward, move the hooks from position 7 to lower positions.

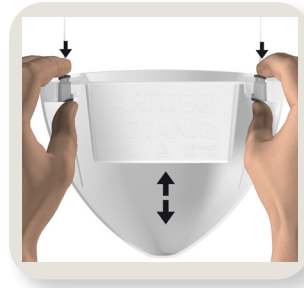
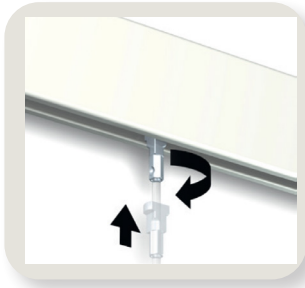

### 4 Reinsert cords into the track

- Insert the cords into the track by twisting them 1/4 on themselves.



#### IMPORTANT

If needed, adjust the height of the Hanging Plant Pot by pressing on the top (head) of the hooks.



*Tilting Forward*



### 5 Adjust Tilting (leaning forward)

- Put the flowerpot into the Hanging Plant Pot. Do not put soil directly into the Hanging Plant Pot.
- If the Hanging Plant Pot tilts forward, adjust the hooks towards position 1. If the Hanging Plant Pot is leaning backward, adjust the hooks towards position 7 (find the numbered holes inside the Hanging Plant Pot).

*Adjust Tilting*



*Hide Cords*



### 6 Hide Cords

- Roll the remaining cords and hide them behind the Hanging Plant Pot.



#### NOTE

Insert one 4-inch flowerpot or two 3-inch flowerpots.

