

Display It LED

PARTS LIST

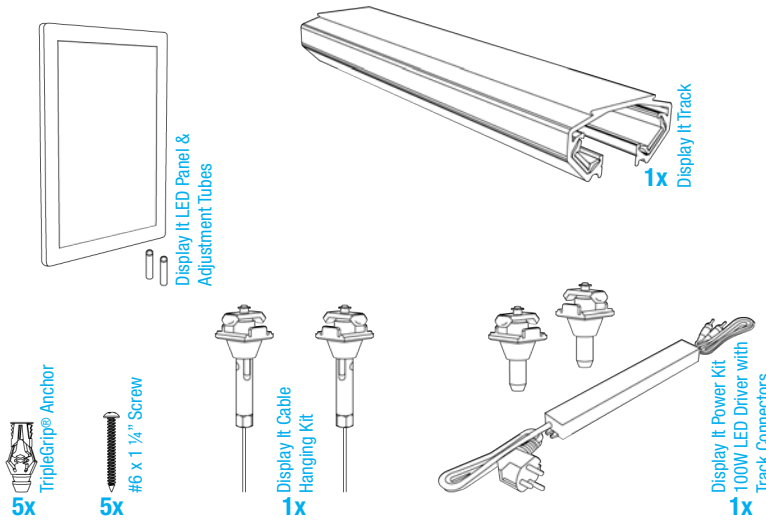

Warning

Display It LED is a 12V electrified product; it is mandatory to follow installation instructions. The ⊕ and ⊖ symbols represent the polarity of the electrical current going through the system.

IMPORTANT

Only one (1) LED Driver can be used per track. Do not exceed the total power (100 watts) per LED Driver.

LED Panels Consumption

Letter (8.5x11): 9 watts
 Tabloid (11x17): 17 watts

Examples

11x Letter LED Panels use a total of 99 watts
 5x Tabloid LED Panels use a total of 85 watts

Mark Holes



Anchors

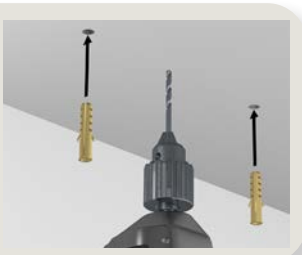

Fasten Track



End-Cap

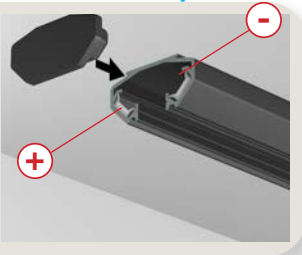

1

Install Track to Wall or Ceiling

- Trial place each track length and mark mounting holes.
- Use a stud finder or drill 1/16" pilot holes to probe for wall or ceiling structure.
- If no structure is present, expand the hole to 1/4" and insert supplied anchors.
- Fasten track to prepared holes with supplied fasteners.
- Finish exposed ends with provided End-Caps.



NOTE

The ⊕ and ⊖ symbols are there for reference only. The panels will be connected to a power outlet and electrified only at the end of the installation.

2

Insert Cable Hanging Kit

- Insert and twist the first Cable Hanging Adaptor into the installed track. Tighten using the conical part of the Cable Hanging Adaptor.
- Verify where the printed white arrows point to.
- Insert the second Cable Hanging Adaptor pointing printed white arrows to the opposite side of the first Cable Adaptor installed.

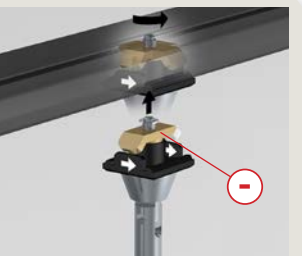
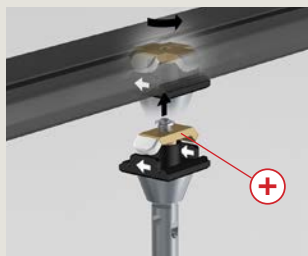

Metallic Adjustment Tube



Insert Hanging Cable in Tube



Multiple Panels per Column



Orientations

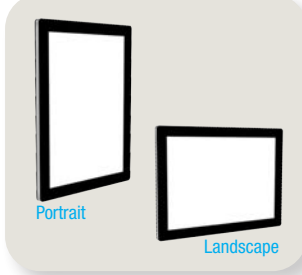

3 Install Panels

- **THIS IS MANDATORY.** Insert the metallic adjustment tubes in the holes designed for this purpose at each top corner of the panel. Do not push on the tube, they must not be fully inserted into the panel. Tubes are needed to adjust the panel height and to remove the cable from the panel.



IMPORTANT

The tube activates the panel's internal adjustment mechanism. If not used, the cable passing through the panel will never be removable and the height of the panels won't be adjustable. Tubes must be used at both top corners of each panel regardless of the orientation (portrait or landscape).

- Insert the hanging steel cable in the metallic adjustment tube, then in the panel until the cable comes out at the bottom of the panel.
- Follow the same steps for all panels to be installed.



NOTE

When installing more than one panel per column, do not forget to use the metallic adjustment tubes on each additional panel.

Install Track Connectors



Printed White Arrows



4 Install Power Kit & Track Connectors

- Install both Track Connectors at the end of the track. Find the printed white arrows on both Track Connectors. Make sure the white arrows point opposite directions to have a positive and negative pole (same orientation as the Cable Hanging Adaptors previously installed).
- Insert Power Kit Cables into each Track Connectors. Make sure to respect polarity: red cable goes on ⊕ and black goes on ⊖.
- It's time to display your images. Open both side of the Panel and insert your printed translucent papers.



PAPER RECOMMENDATION

Translucent paper is recommended to achieve the best look with LED panels. Using conventional paper is not advised, it will diminish the brightness and look of your content. Translucent paper example: Xerox Never Tear.

Insert Power Kit Cables



Insert Images

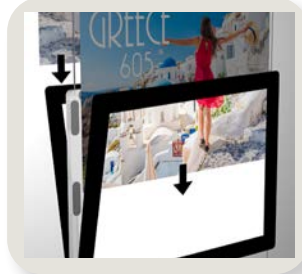

Plug Into Outlet

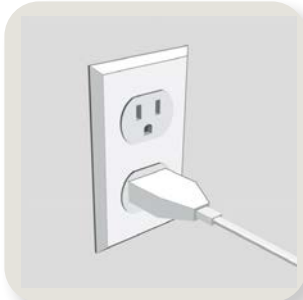

Adjust Panels



5 Connect Power

- Plug the LED Driver into a 110V electrical outlet. The panels should illuminate.



IMPORTANT

If the Panels don't light up, verify the polarity (⊕ ⊖).



NOTE

You can always adjust panel height and level it after installation by pushing the top of the small metallic tube.

ASHanging.com
866.935.6949

© 2022 AS Hanging Display Systems
All rights reserved, printed in Canada
22L-23pi

If you have any questions, please call our Customer Service Center at 866-935-6949.