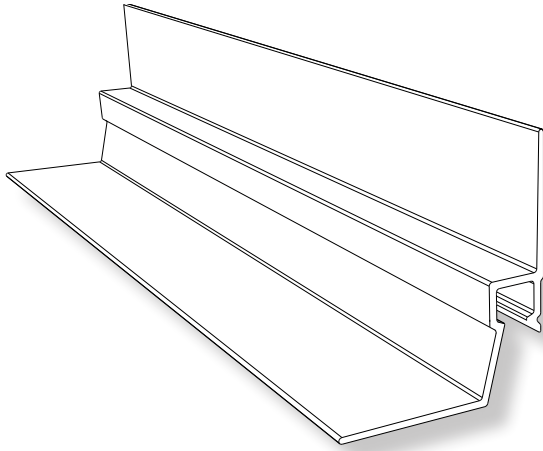

Drop Ceiling Track  
A1080HF**Warning**

The track is supplied with screws and TripleGrip™ plastic screw anchors that are suitable for mounting the track to drywall, lathe and plaster, concrete, wood, structural lumber and metal studs. All holes in track should be filled with a suitable screw/fastener combination.

Property damage and personal injuries can occur from track mount failure. To prevent such failure it is the responsibility of the installer to select a suitable fastener for a specific installation.

**1 Check Walls**

- The wall should be straight, Drop Ceiling Track is rigid and does not easily bend.
- Normal track orientation is horizontal.

Straight Wall



Non-linear Wall

**2 Measure**

- Measure your ceiling segments. Drop Ceiling Track replaces the corner profile (perimeter L Molding) used in recessed ceiling.

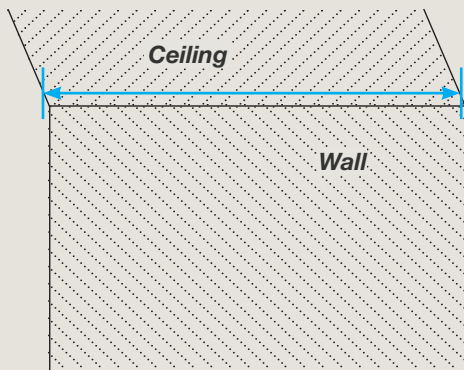
**3 Cut or Trim Track**

- Cut track as needed and remove all burrs.

**TIP**

Cut the track with a hack saw and miter box or power miter saw with proper blade.

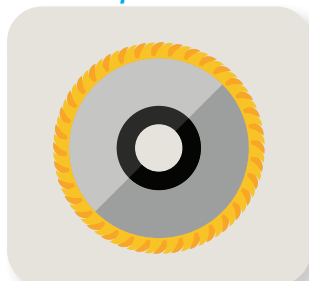
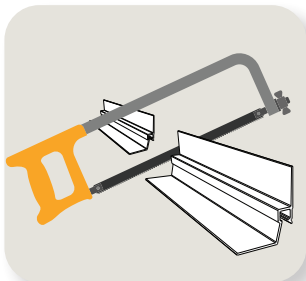
**Proper Blade**

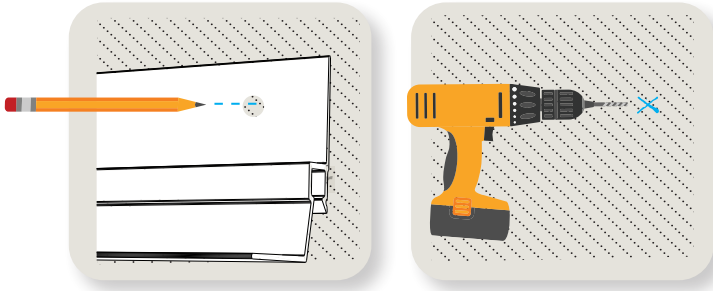

## 4 Mark and Prepare Holes

- Trial place each track length and mark mounting holes.

### TIP

Use a level to make certain track is level.

- Use a structural detector or drill 1/16" pilot holes to probe for wood or metal structure.

### Anchor

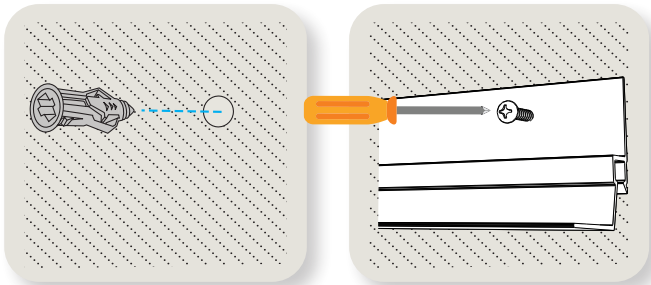

## 5 Mounting Track on Walls

- If no structure is present, expand the hole to 1/4" and insert supplied screw anchors.
- Fasten track to prepared holes with supplied fasteners.

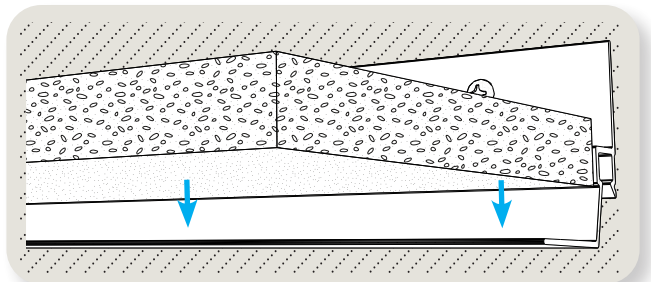

## 6 Install Recessed Ceilings

- Follow the instructions provided by the supplier of the suspended ceiling purchased. The Drop Ceiling Track replaces the corner profile (perimeter L Molding) used in recessed ceiling.