

Top Clamp H3045 / H3046 / H3047

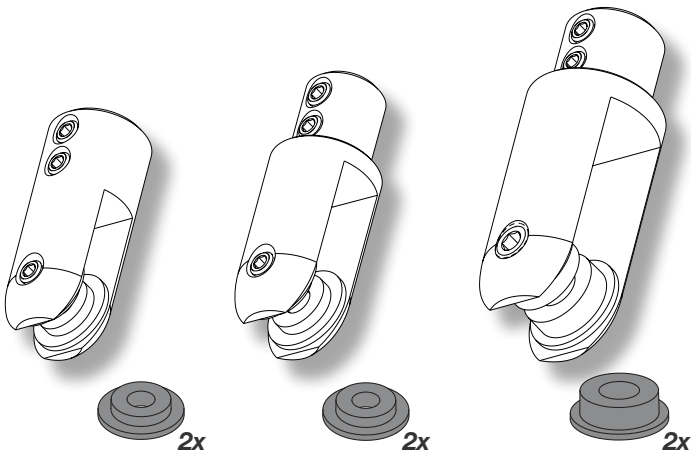

Warning

Top Clamps are designed for use with tempered monolithic glass sheet and includes bushings to buffer the glass from contact with metallic hardware. These must be used if display panels are made of glass. Bushings are optional when panels are made of other materials. Top Clamps must be used with 1.8 mm diameter steel/stainless steel cables as provided by the company. Never use with nylon cords. Cables are to support the load in a vertical orientation only.



NOTE

AS Hanging Display Systems offers a "Cable Trim Kit" (PN U5150AA) for your convenience and it may be very helpful in this installation.

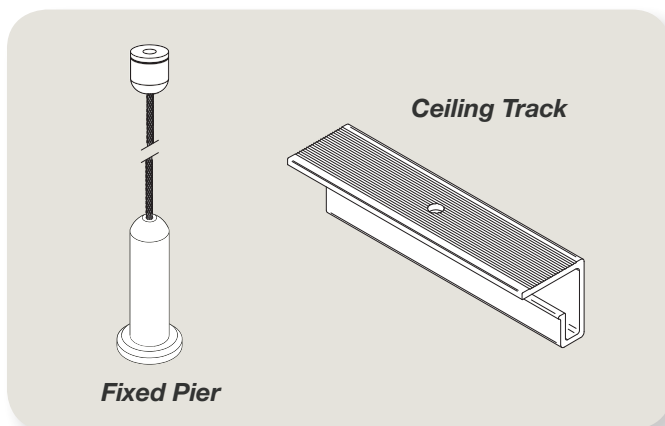

1

Preparation

- Install the upper support system (i.e. Fixed Piers, Ceiling Track, for example) that will be used to support the presentation. Refer to respective Installation Guides that are supplied with these products.
- Select steel/stainless steel cables (i.e. P-End, J-End, etc.), that are compatible with the upper support system.

2

Install Top Clamps

- Remove and retain the long set-screw on the clamp end of the Top Clamp.
- Insert one bushing in each side of the prepared hole within the glass panel.
- Slide the Top Clamp over the glass and bushings and thread the set-screw into the clamp hole and through the entire assembly. This only need be tightened until the screw bottoms out in the opposite side of the Top Clamp.
- Repeat with the second Top Clamp for this panel. Repeat for each panel.

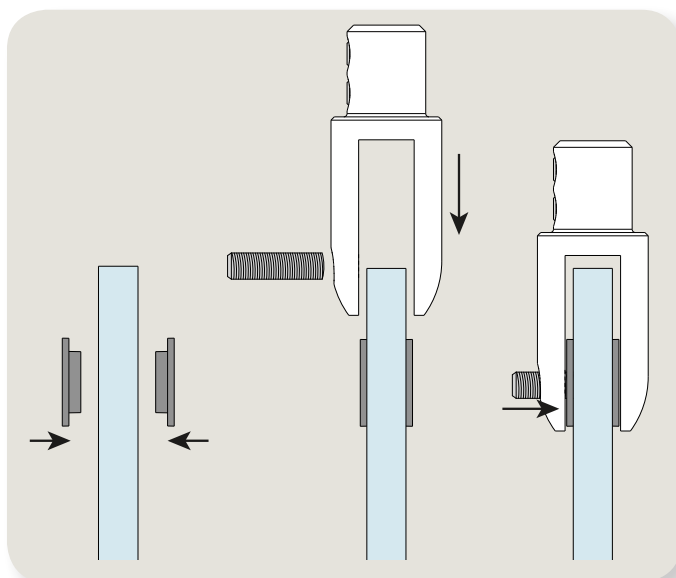

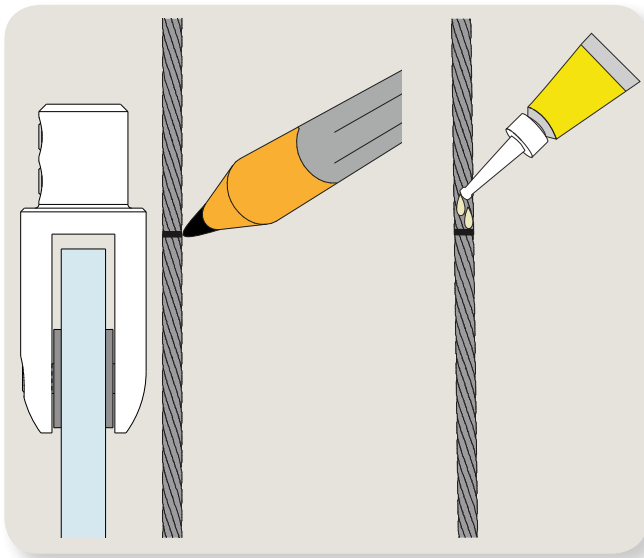

3 Prepare Cable

- Position cables where you would desire to locate the display panels.
- Using a fine-point marking pen, mark the cables at the location where you desire the top edge of the glass to be located.
- Using cyanoacrylate adhesive (supplied in mentioned Cable Trim Kit), apply one or two drops to the mark. Allow 1 – 5 minutes to dry.
- Cut the cables on their respective marks.

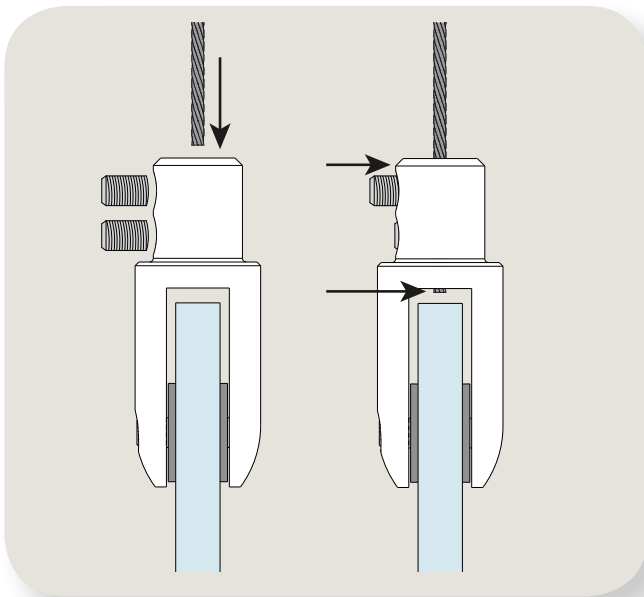

4 Complete Assemblies

- Loosen the cable set-screws at the top end of each Top Clamp.
- Remove cables from their suspended positions and insert the trimmed end into the Top Clamp assemblies. Feed cable through until it barely extends into panel cavity as shown.
- Tighten both set-screws with supplied Allen key.

5 Install Panels

- Hang cables, now with attached panels, back into their final position. Care should be given to support the panel until both Top Clamps are fully suspended.



Do not overload one Top Clamp with the entire weight of a panel during installation.